

MODEL	D
SM2863-5155	305
SM2863-5126	800

T IS THE EARTH TERMINAL.

Dimensions in mm.

FEATURES CARATTERISTICHE		
MODEL MODELLO		SM2863 - 5155 (SM2863 - 5126)
BASIC STEP ANGLE		1.8° ± 0.09°
BIPOLAR PARALLEL CURRENT	(Amp)	4
RESISTANCE	(Ohm)	1
INDUCTANCE	(mH)	7.9
BIPOLAR HOLDING TORQUE	(Ncm)	920
ROTOR INERTIA	(Kg <sup>m</sup> · x 10 <sup>-7</sup> )	4500
THEORETICAL ACCELERATION	(rad x sec. <sup>-2</sup> )	20500
BACK E.M.F.	(V/Krpm)	241
MASS	(Kg)	4
INTERNATIONAL STANDARDS		UL, CSA, CE, RoHS
INSULATION VOLTAGE	(V)	250 V <sub>Ac</sub> (350 V <sub>Dc</sub> )
PROTECTION DEGREE - INSULATION CLASS		IP43 - F
LEADS CODE		V

Codes between brackets refer to double shaft models.  
Le sigle fra parentesi si riferiscono ai modelli bialbero.

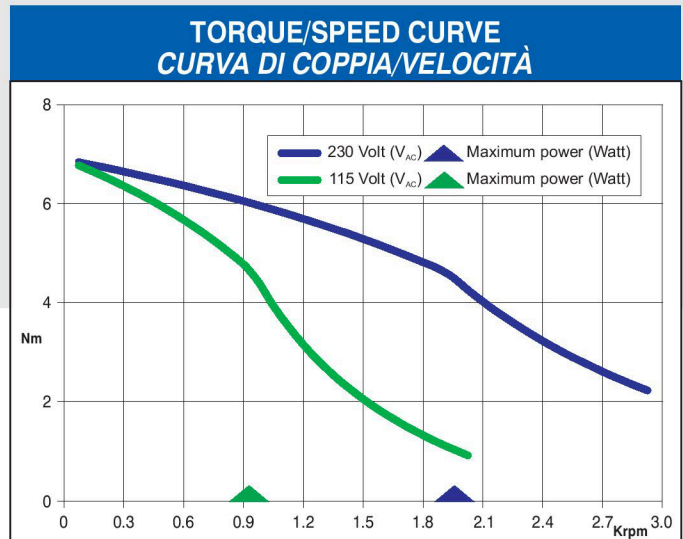

SANYO DENKI CO., Ltd (JAPAN)

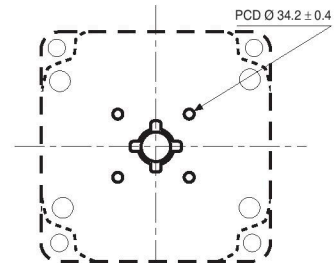
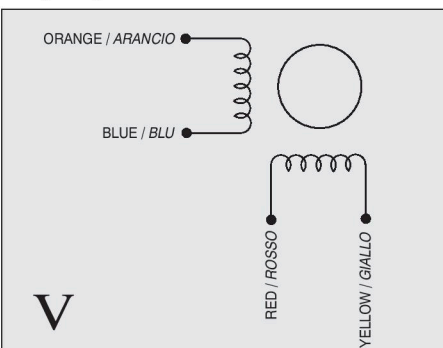

DOUBLE SHAFT MOTORS ONLY.  
4 X M4 THREADED HOLES. TAP DEPTH 4.5 mm.